

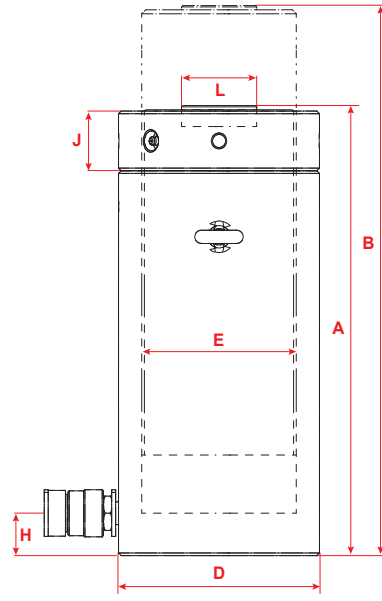

Oynar başlık opsiyoneldir  
Tilting saddle is optional



- › 30-1.100 tona kadar kilit somunlu silindirler
- › 50-300 mm arası stroke seçeneği
- › Spesifik uygulamalar için özel imalat imkanı
- › Tek etkili, yük dönüşlü standart hidrolik sistem
- › Stroke aşım valfi ile üst düzey iş güvenliği
- › Vidalı piston ile uzun süre yük altında bekleme
- › Endüstriyel ağır işlere dayanıklı sağlam yapı
- › 2 yıl garantili, Türkiye'de yedek parça ve servis
- › Lock-nut hydraulic cylinders from 50 to 1.100 tons
- › 50-300 mm stroke options for various applications
- › Custom manufacturing for specific applications
- › Single-acting, load-return standard hydraulic system
- › Hydraulic "end of stroke" overflow port for security
- › Lock nut (screw piston) holds the load mechanically
- › Robust construction resistant to heavy industrial work
- › 2 year warranty, spare parts and service in Turkey

### Tamamlayıcı Ekipmanlar / Complementary Equipment

El Pompaları / Hand Pumps

Güç Üniteleri / Power Packs

700 Bar Hortumlar / Hoses

Manometreler / Gauges

Kaplinler / Quick Couplings



Ürünlerin devamı için sonraki sayfaya bakınız.  
See next page for more.

Parça Part	Kapasite Capacity		Stroke	Etki Alanı Effect Area	Yağ Hacmi Oil Cap.	Ölçüler (mm) Dimensions						Ağırlık Weight	
	Ton	kN				mm	cm <sup>2</sup>	cm <sup>3</sup>	A	B	D		E
NLN03005	30	303	50	44	221	169	219	100	75	25	30	45	10.3
NLN03010	30	303	100	44	442	219	319	100	75	25	30	45	13.2
NLN03015	30	303	150	44	663	269	419	100	75	25	30	45	17.2
NLN03020	30	303	200	44	884	319	519	100	75	25	30	45	19.2
NLN03025	30	303	250	44	1105	369	619	100	75	25	30	45	22.5
NLN03030	30	303	300	44	1325	419	719	100	75	25	30	45	25.9
NLN05005	50	487	50	71	355	155	205	125	95	25	21	61	15
NLN05010	50	487	100	71	709	205	305	125	95	25	21	61	20
NLN05015	50	487	150	71	1062	260	410	125	95	25	21	61	25
NLN05020	50	487	200	71	1418	310	510	125	95	25	21	61	30
NLN05025	50	487	250	71	1772	365	615	125	95	25	21	61	35
NLN05030	50	487	300	71	2127	415	715	125	95	25	21	61	40
NLN10005	100	911	50	133	664	180	230	170	130	30	31	88	31
NLN10010	100	911	100	133	1327	230	330	170	130	30	31	88	40
NLN10015	100	911	150	133	1991	285	435	170	130	30	31	88	50
NLN10020	100	911	200	133	2654	335	535	170	130	30	31	88	59
NLN10025	100	911	250	133	3318	390	640	170	130	30	31	88	69
NLN10030	100	911	300	133	3981	440	740	170	130	30	31	88	78



Parça Part	Kapasite Capacity		Stroke	Etki Alanı Effect Area	Yağ Hacmi Oil Cap.	Ölçüler (mm) Dimensions						Ağırlık Weight	
	Ton	kN				mm	cm <sup>2</sup>	cm <sup>3</sup>	A	B	D		E
NLN14005	140	1380	50	201	1005	201	251	200	160	35	38	111	49
NLN14010	140	1380	100	201	2011	251	351	200	160	35	38	111	61
NLN14015	140	1380	150	201	3016	311	461	200	160	35	38	111	76
NLN14020	140	1380	200	201	4021	361	561	200	160	35	38	111	88
NLN14025	140	1380	250	201	5026	421	671	200	160	35	38	111	103
NLN14030	140	1380	300	201	6032	471	771	200	160	35	38	111	115
NLN22005	220	2156	50	314	1571	208	258	250	200	40	40	131	79
NLN22010	220	2156	100	314	3142	258	358	250	200	40	40	131	98
NLN22015	220	2156	150	314	4712	318	468	250	200	40	40	131	121
NLN22020	220	2156	200	314	6283	368	568	250	200	40	40	131	140
NLN22025	220	2156	250	314	7854	433	683	250	200	40	40	131	165
NLN22030	220	2156	300	314	9425	483	783	250	200	40	40	131	184
NLN35005	350	3368	50	491	2545	238	288	310	250	50	50	178	139
NLN35010	350	3368	100	491	4909	288	388	310	250	50	50	178	169
NLN35015	350	3368	150	491	7363	348	498	310	250	50	50	178	204
NLN35020	350	3368	200	491	9817	398	598	310	250	50	50	178	233
NLN35025	350	3368	250	491	12272	458	708	310	250	50	50	178	269
NLN35030	350	3368	300	491	14726	508	808	310	250	50	50	178	298
NLN43005	430	4224	50	616	3079	250	300	340	280	55	55	178	175
NLN43010	430	4224	100	616	6158	300	400	340	280	55	55	178	210
NLN43015	430	4224	150	616	9236	365	515	340	280	55	55	178	258
NLN43020	430	4224	200	616	12315	415	615	340	280	55	55	178	292
NLN43025	430	4224	250	616	15394	480	730	340	280	55	55	178	338
NLN43030	430	4224	300	616	18473	530	830	340	280	55	55	178	373
NLN56005	560	5517	50	804	4021	280	330	390	320	65	60	200	263
NLN56010	560	5517	100	804	8042	330	430	390	320	65	60	200	310
NLN56015	560	5517	150	804	12064	395	545	390	320	65	60	200	370
NLN56020	560	5517	200	804	16085	445	645	390	320	65	60	200	417
NLN56025	560	5517	250	804	20106	510	760	390	320	65	60	200	478
NLN56030	560	5517	300	804	24127	560	860	390	320	65	60	200	524
NLN67005	670	6600	50	962	4811	305	355	430	350	65	75	200	343
NLN67010	670	6600	100	962	9621	355	455	430	350	65	75	200	400
NLN67015	670	6600	150	962	14432	420	570	430	350	65	75	200	473
NLN67020	670	6600	200	962	19242	470	670	430	350	65	75	200	530
NLN67025	670	6600	250	962	24053	535	785	430	350	65	75	200	604
NLN67030	670	6600	300	962	28863	585	885	430	350	65	75	200	660
NLN88005	880	8620	50	1256	6283	325	375	490	400	70	85	250	474
NLN88010	880	8620	100	1256	12566	375	475	490	400	70	85	250	548
NLN88015	880	8620	150	1256	18849	440	590	490	400	70	85	250	643
NLN88020	880	8620	200	1256	25133	490	690	490	400	70	85	250	717
NLN88025	880	8620	250	1256	31416	555	805	490	400	70	85	250	813
NLN88030	880	8620	300	1256	37699	605	905	490	400	70	85	250	886
NLN110005	1100	10905	50	1590	7952	340	390	550	450	80	95	325	681
NLN110010	1100	10905	100	1590	15904	420	520	550	450	80	95	325	773
NLN110015	1100	10905	150	1590	23856	485	635	550	450	80	95	325	894
NLN110020	1100	10905	200	1590	31808	535	735	550	450	80	95	325	987
NLN110025	1100	10905	250	1590	39761	600	850	550	450	80	95	325	1107
NLN110030	1100	10905	300	1590	47713	650	950	550	450	80	95	325	1200