

One of the most powerful and impressive sewer pipe cleaning nozzles is the Bomb Nozzle. Due to its high power and heavy weight, it can readily pass through rocks and material on the bottom of the pipes. Highly resistant to chemical environments, SMC's Bomb Nozzle includes an internal divider which equally divides inlet water between outlets and allows the nozzle to move smoothly. A curve inside this nozzle allows the water to flow through the pipe without any head loss. The water outlet, located at the rear of the nozzle, is at different angles, thereby increasing the cleaning effect.

Most wastewater pipes are old and worn, and when exposed to high-pressure water, the water outlets of the nozzle can become damaged by the walls of these pipes. Therefore, two

types of inserts of this nozzle are available. According to the operator's opinion, they are interchangeable and able to be combined in order to prevent damage to the pipe walls while the nozzle passes through the pipe. The seats of insert Nozzles are designed with an angle so that they do not hit the pipe walls. Because the sediments and materials stick to the nozzles, our know-how professional team has developed a practical method to be used in operations: installing inserts by pressure and keeping them in place using a threaded cap.

Please refer to the Round Jet Nozzles section in the High-Pressure Nozzles category in order to select the nozzle which meets your requirement.

Without Divider

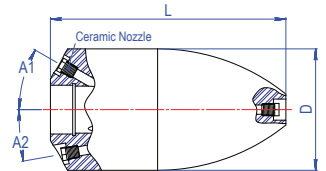

Order Number	Part Number	W.P.		Connection	D (mm)	L (mm)	Insert Nozzles	Nozzle Type	A1	A2	Q (l/min)	Weight (kg)
		bar	psi									
BM02	BM3-B24-FBB-01	250	3650	Female-1" BSPP	79	176	11	M10x1	5x30°	5x10°	50-250	4.5
BM03	BM3-B26-FBB-01	250	3650	Female-1,1/4" BSPP	98	190	11	M10x1	5x30°	5x10°	50-250	7

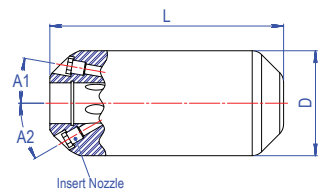

Order Number	Part Number	W.P.		Connection	D (mm)	L (mm)	Insert Nozzles	Nozzle Type	A1	A2	Q (l/min)	Weight (kg)
		bar	psi									
BM04	BM3-B24-BB-01	250	3650	Female-1" BSPP	79	176	10	M10x1	5x10°	5x30°	50-250	5.5
BM05	BM3-B26-BB-01	250	3650	Female-1,1/4" BSPP	98	190	10	M10x1	5x10°	5x30°	50-250	9

Divider Included

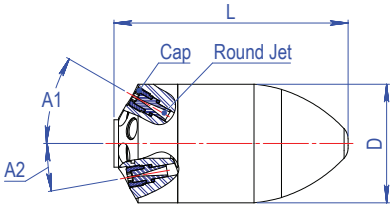

Order Number	Part Number	W.P.		Connection	D (mm)	L (mm)	Insert Nozzles	Nozzle Type	Cap Size	A1	A2	Q (l/min)	Weight (kg)
		bar	psi										
BM01	BM3-B20-BB-01	250	3650	Female-3/4" BSPP	80	158	10	Round jet	M14x1	5x30°	5x10°	50-250	4